

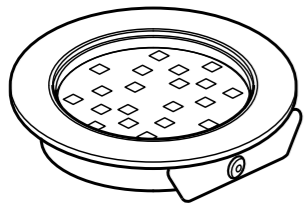

24V LED Downlight luminaires

Installation & maintenance guide



Esper

This luminaire MUST be installed by a qualified electrician.
Read these instructions carefully. Once installation is complete give them to the person responsible for general maintenance and cleaning. Please keep these instructions for future reference.

1

Esper

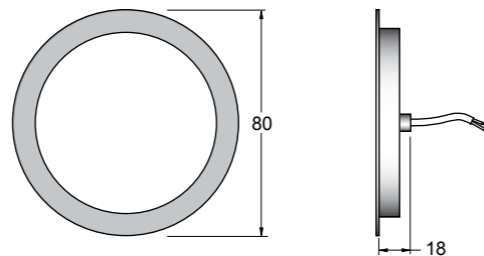
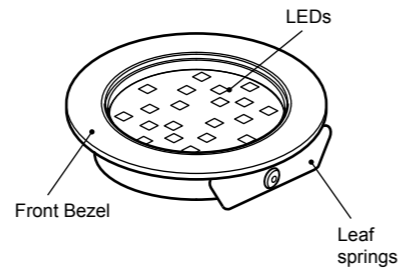

2

Technical data



This luminaire has an IP 54 rating.



Class 3 product.



Suitable for installation on flammable surfaces.

Luminaire	Cut-out	Lamp	Circuit
Esper	65mm	LED	24v

Zones

Only for use in **All areas outside of 'Zone 0'**

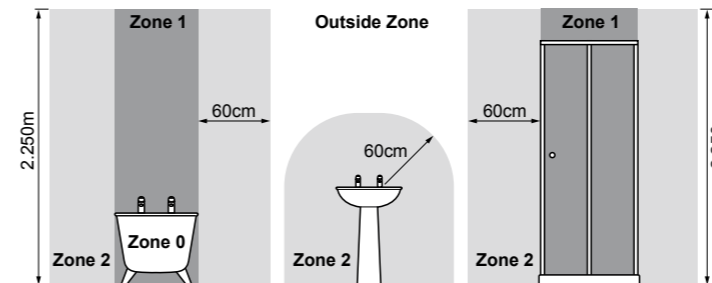

3

Guarantee

The Light Corporation Ltd ("We") guarantee this product in the UK for 12 months from date of purchase. This guarantee is invalid if the product is installed in an improper working environment or not according to current I.E.E Wiring Regulations (BS7671), for improper use or has been tampered with in any way. Should this product fail during the guarantee period it will be replaced free of charge, subject to correct installation and return of the faulty unit. We do not accept responsibility for any installation costs associated with the replacement of this product. We reserve the right to alter specifications without prior notice. This does not affect your statutory rights.

Warnings!



WARNING! - TO PREVENT ELECTRIC SHOCK - Always switch off electricity supply and circuit breaker or withdraw the fuse before installation and maintenance.

- **NEVER** alter the luminaire in anyway from its original specification.
- **IMPORTANT** ensure free air movement around the luminaire. Remove any insulation material from at least 100mm around the hole.
- **NEVER** cover the luminaire with insulating or similar materials.
- Install luminaire in accordance with building regulations and the current edition of the IEE wiring regulations (BS 7671: Requirements for electrical installations).
- Check for hidden pipes and cables before installation.
- Take care when using power tools, follow the safety instructions provided with them.

4

Warnings!

- This luminaire cannot be maintained in any way by the user.
- This luminaire qualifies as WEEE and should be disposed of accordingly.
- **DO NOT** dispose of this luminaire with normal household waste, take to a local authority recycling centre.
- Dispose of packaging correctly after installation.



Drivers

The luminaire MUST be connected to a driver and not directly to the mains electricity supply.

When installing LED luminaires always ensure the number of luminaires to be run from a single driver does not exceed the maximum for that driver.

For details of how many fittings can be run from each LED driver or for further advice regarding the specification of LED drivers please contact us directly - see the contact details in the contacts section of this leaflet.

5

Installation

Tools required: Suitable size hole cutter, Philips screwdriver, Small flat-blade electrical screwdriver.



WARNING! - TO PREVENT ELECTRIC SHOCK - Always switch off electricity supply and circuit breaker or withdraw the fuse before installation and maintenance.

If replacing an existing luminaire, make a note of the connections.

1. Cut the correct sized hole in the ceiling in the required position:

Esper - 65mm hole

IMPORTANT! Avoid any joists, pipes or cables beneath the surface.

2. Install the driver in accordance with IEE electrical regulations (BS 7671).

Follow the safety and installation instructions supplied with the driver.

The Esper is a Constant Voltage unit and must be wired in parallel. The LED will be destroyed if not used in conjunction with an appropriate constant voltage driver.

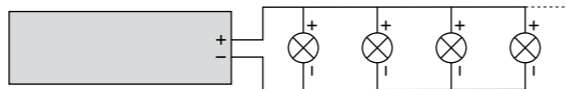

Wiring Diagram - Constant voltage must be wired in parallel

6

Installation

3. Push the wires up through the ceiling hole.

Fully squeeze both leaf springs and locate the luminaire into the cut-out, allowing the leaf springs to hold it securely in position.

Finally, connect the wires coming from the luminaire to the driver.

Installation is now complete.

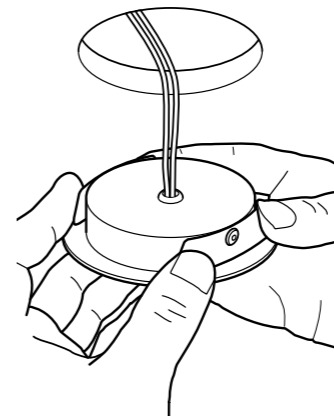

7

Maintenance / Contacts



WARNING! - TO PREVENT ELECTRIC SHOCK - Always switch off electricity supply and circuit breaker or withdraw the fuse before maintenance.

This luminaire cannot be maintained in any way by the user

Cleaning

Only use a soft damp cloth when cleaning.

Our full range of products are available at:

www.lightcorporation.com

The Light Corporation Ltd

Unit 3 North Bridge Road
Berkhamsted
Hertfordshire
HP4 1EF
United Kingdom



www.lightcorporation.com
e-mail: info@lightcorporation.com

Tel: +44 (0) 1442 216200
Fax: +44 (0) 1442 873136

